

1 Nature Trail

The Horniman Nature Trail is the oldest in London. We look after the trail to encourage plants to grow, and birds and insects to visit. We have a pond, meadow, and a log pile area. We have even found the endangered stag beetle living on the trail.



2 Papyrus

This papyrus plant, *Cyperus papyrus*, is similar to the papyrus used in Ancient Egypt to make paper. This plant is from a warmer climate than London. We protect plants like this from cold winters by digging them up and putting them in a greenhouse until spring.



3 Wollemi pine

The Wollemi pine grows in our Jurassic Garden. It is the only species left of an ancient type of tree that grew over 65 million years ago, when dinosaurs still walked the earth.



4 Barkcloth

Barkcloth is a type of material made from the inner bark of the Mutuba tree in Fiji. Lots of things are made from barkcloth including headdresses, masks and body decorations (for both ceremonial and every day wear). What patterns can you see on this piece of barkcloth?



5 Wedding basket

This basket, known as a *sintong* (wedding basket), is from Malaysian Borneo. It was made by weaving the leaves of climbing palm trees together. It is called a wedding basket, because it is said to have been used to carry things during a wedding ceremony.



6 Nabu

A *nabu* is a bracelet worn on the upper-arm. This nabu is from Papua New Guinea. It is made from bark, rope and a strip of Pandanus leaf. The name of this nabu, *kenoni nabu*, comes from the zig-zag decoration called *kenoni*.



7 Tea caddy

This special box, used for storing tea, was purchased by Frederick Horniman. Tea is made from the hand-picked leaves of tea plants. The leaves are dried and then shipped to the UK from countries like India and China. Mr Horniman made his fortune trading tea.



8 Cassava grater

Cassava is a root vegetable and important food crop in South America. It has to be prepared carefully to remove a natural poison called cyanide. This cassava grater was made by the Waiwai people who live in Guyana in the Amazon rainforest.



9 Sheng mouth organ

The pipes of this Chinese mouth organ, are made from different-sized lengths of bamboo. Bamboo has been used because it is hollow, allowing air to blow through it. Bamboo is a quick-growing grass that can grow up to 20 meters high!



10 Nature Base bees

Bees live in hives with a queen bee and thousands of worker bees. The number of wild bees is in decline worldwide. The plants we grow are important – flowers with lots of nectar and pollen encourage bees into our gardens. The bees then pollinate plants so they can grow new seeds.



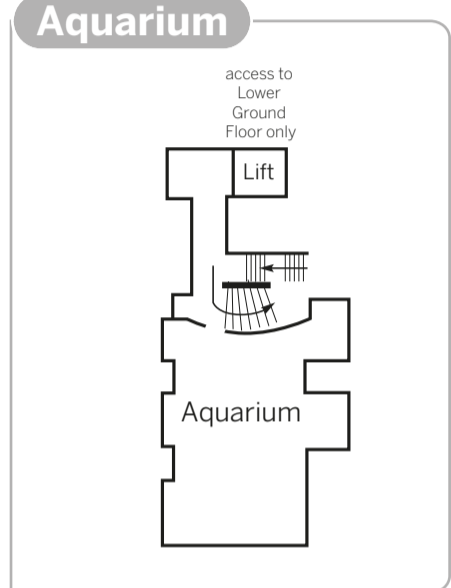
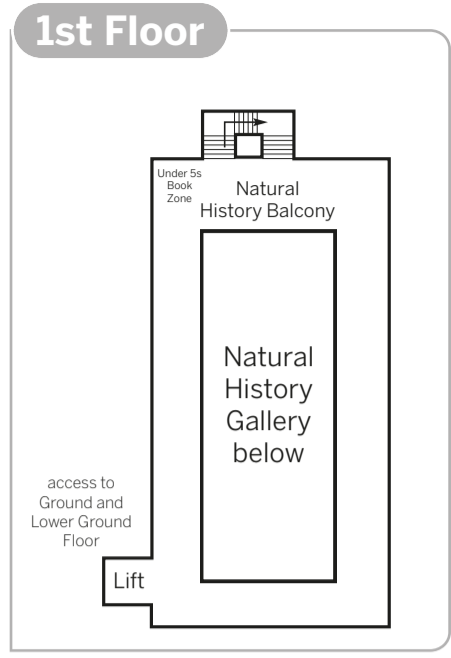
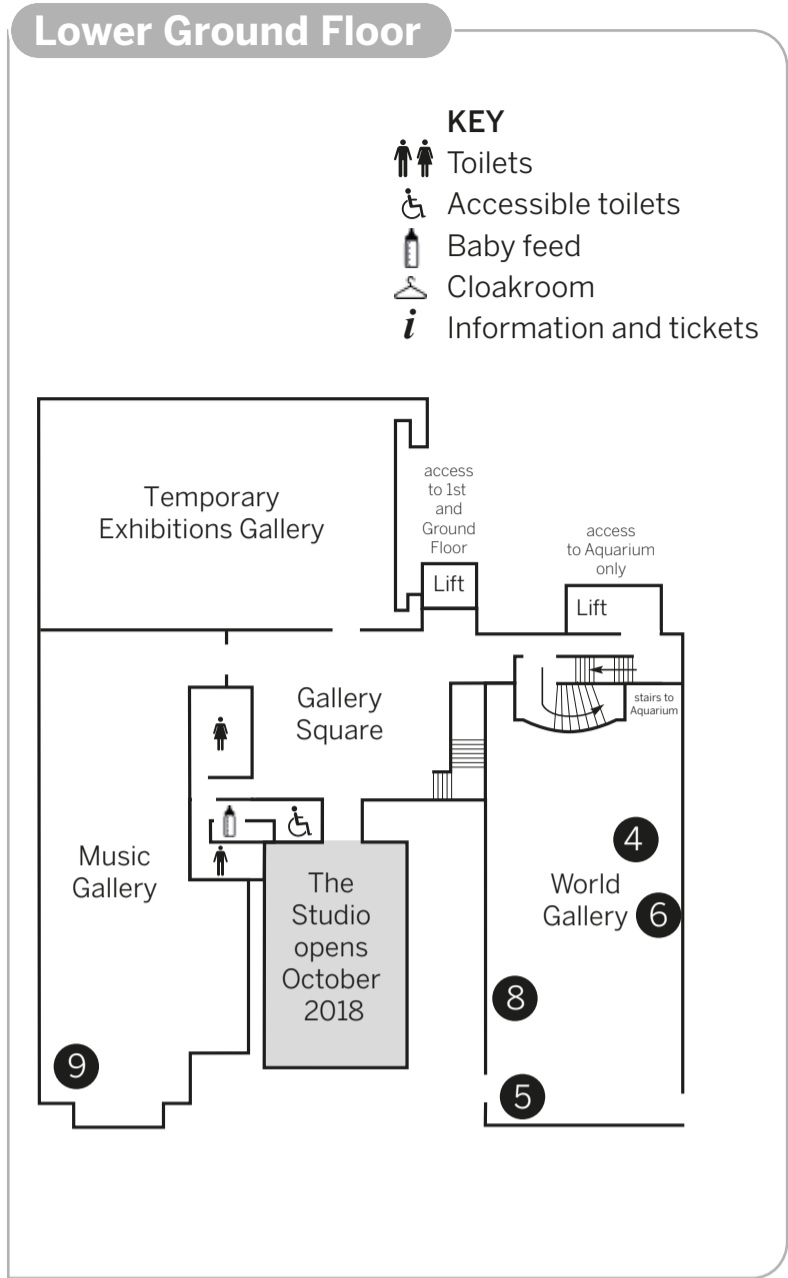
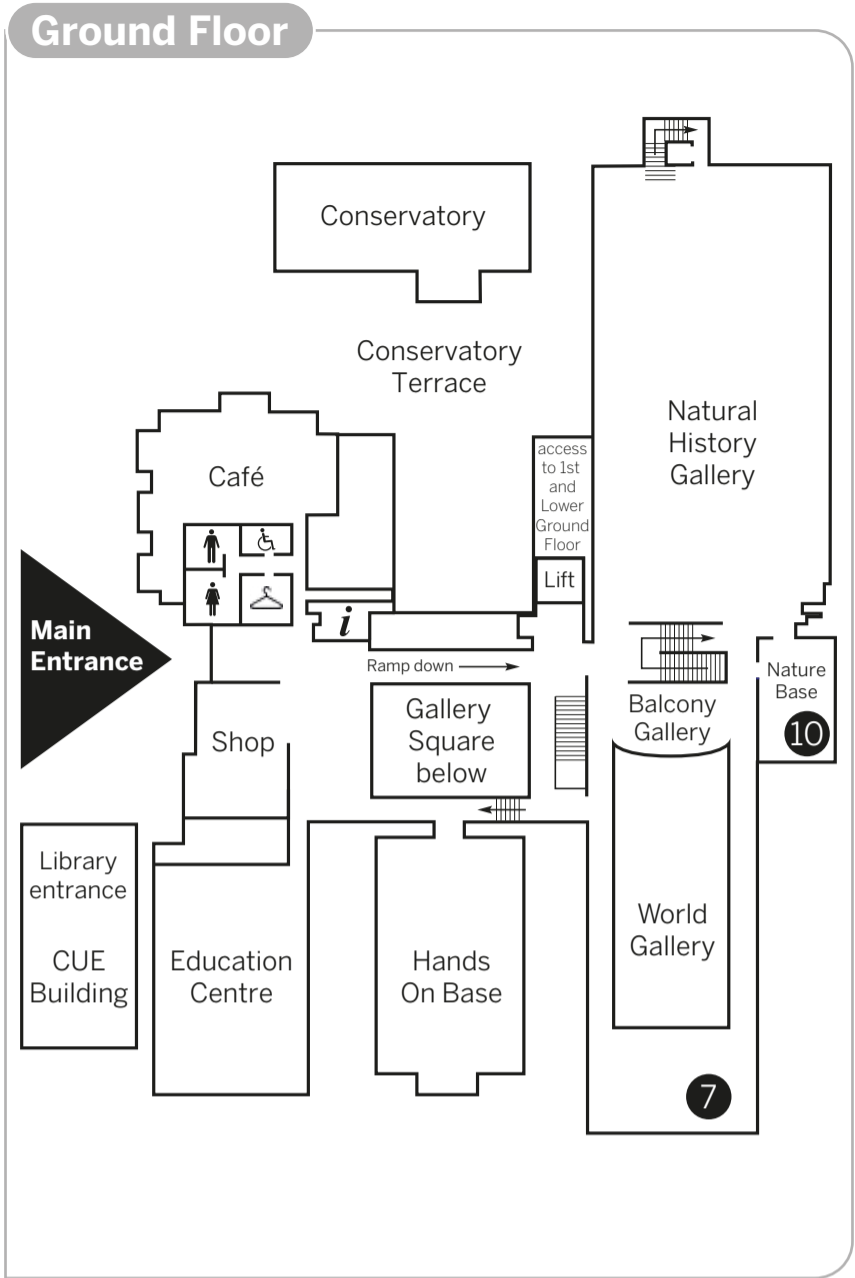

- PLANTS OBJECTS**
- 1 Nature Trail
 - 2 Papyrus
 - 3 Wollemi pine
 - 4 Barkcloth
 - 5 Wedding basket
 - 6 Nabu
 - 7 Tea caddy
 - 8 Cassava grater
 - 9 Sheng mouth organ
 - 10 Nature Base bees

